



## **AITA Ceramic™ Products Installation Manual**

We strongly recommend the ceramic bearing and related products installed by a qualified mechanic, and all the installations have to be done with the proper tools.

### **Preparation**

Remove old bottom bracket, bearing or jockey wheels with proper tools without damaging the frame, hub and derailleur cage.

Clean and remove all dirt, old grease if you are installing the products in a used bike.

Apply a thin layer of grease on the inside of the bottom bracket or hub shell and the outside of the bearing or bottom bracket cups.

### **Installation**

#### **Thread bottom bracket**

Use a correct bottom bracket spanner for the English or Italian thread bottom bracket installation with torque at 40NM.

#### **Pressfit bottom bracket with cups**

Use a proper bottom bracket press tool for the installation. Please make sure a correct size drift has been selected which is large enough to cover the outside of the bottom bracket cup.

#### **Bottom bracket for SRAM GXP cranks**

This type of bottom bracket may come with a 2mm width black plastic spacer and a silver metal wave washer.

Both the black plastic spacer and the silver metal wave washer are not required in most cases.

However, if you have already used a similar spacer or wave washer with your current bottom bracket, and then you will apply the same to our bottom bracket to eliminate the play.

Depend on the space/play, please pick either the black plastic spacer or wave washer, or both and install them on the **Drive Side**.

#### **Instructions for specific bottom brackets**

##### ***Pressfit30/EV0386/BBright***

A 30mm ID wave washer is provided and can be used on the **Drive Side** to eliminate any plays.

Please install the bottom bracket and crank without the wave washer first. If any play appears in

between the crank arm and the bottom bracket, please redo the installation with the wave washer on the **Drive Side**.

Additional 30mm ID x 2mm width plastic spacer(s) are provided with MTB version bottom brackets. Use the spacers upon the width combinations of your frame shell and the cranks.

### ***PressFit30 OSBB Shimano/SRAM***

Included with this bottom bracket are 2 x 3mm plastic spacers/rings with 46mm ID. Those are used only for Specialized OSBB carbon shells with 62mm width.

Place one 3mm plastic spacer/ring on each side of the bottom bracket cup before pressing into the bottom bracket shell.

### ***BB86 EVO386***

Bottom bracket comes with 1.5mm width plastic spacer(s) and a metal wave washer. For a standard EVO386 compatible crank into a BB86 bottom bracket shell, no spacer or wave washer is required. So please install the bottom bracket and crank without the wave washer first. If any play appears in between the crank arm and the bottom bracket, please redo the installation with the wave washer on the **Drive Side**.

The 1.5mm width plastic spacer(s) are provided if you need to adjust the bottom bracket width to match different 30mm spindle cranks.

### ***Campagnolo Ultra Torque***

Campagnolo Ultra Torque Lock Ring and Bearing Clip are NOT required. Instead, please use provided 2 x wave washers for both sides as shown below.

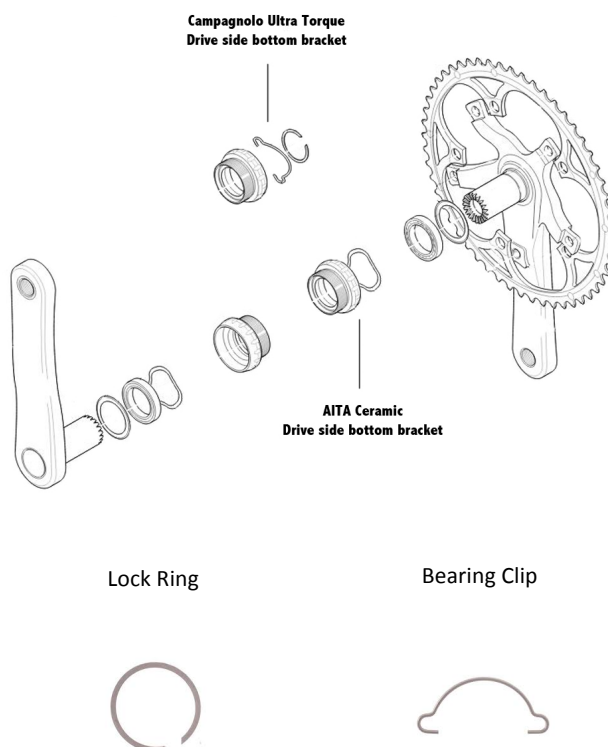

### **BB30 Shimano/SRAM**

Please follow the diagram to install the bottom bracket for road frames.

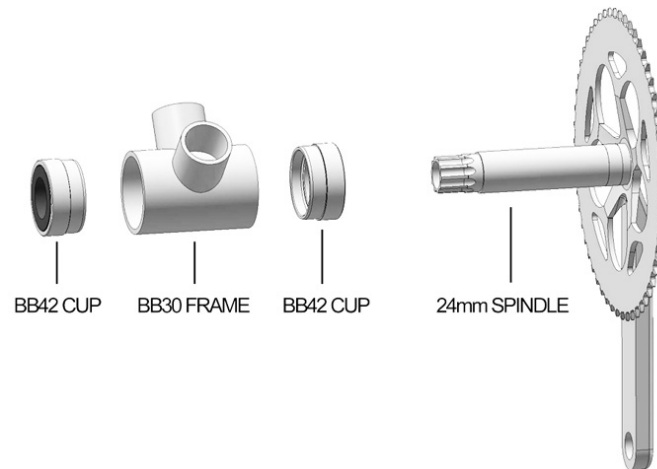

### **BSA30**

Bottom bracket comes with 2mm width plastic spacer(s) and a metal wave washer. For a standard EVO386 compatible crank into a BSA bottom bracket shell, no spacer or wave washer is required. So please install the bottom bracket and crank without the wave washer first. If any play appears in between the crank arm and the bottom bracket, please redo the installation with the wave washer on the **Drive Side**.

The 2mm width plastic spacer(s) are provided if you need to adjust the bottom bracket width to match different 30mm spindle cranks.

An oversize bottom bracket spanner is provided to assist with the BSA bottom bracket cup installation.

### **Rear derailleur pulleys**

AITA ceramic pulleys are CNC machined, hence there are no difference in between upper and lower wheels.

All our pulleys are 11-speed compatible with Shimano, SRAM and Campagnolo.

All our pulleys also work with 10-speed Shimano and SRAM rear derailleurs with spacers. There are 4 metal spacers in the package and use 1 spacer on each side of pulley wheel (on top of the dust cover) to build up the width for the 10-speed system.

We also provide a separate 4mm ID metal sleeve for the SRAM 4mm bolt. So please select the option if you need it.

**Important:** All the pulleys are full ceramic bearing standard, there is no grease or oil required for the lubrication.

Please feel free to contact [info@aitaceramic.com](mailto:info@aitaceramic.com) if you have any questions in terms of the products or installations.